

**Model No. B-OPA-0296****FEATURES**

- No Lubrication required
- Long-life polymer compression ring
- Easy to install repair kits available
- Sealed, permanently lubricated bearings
- Automatic thermal overload protection
- Heavy-duty electric motor

**OPERATING CHARACTERISTICS:**

- Optimum life and performance achieved at a 50% duty cycle.
- Optimum ambient temperature range -10°F to 100°F

**OPERATING SPECIFICATIONS**

Horsepower	1.5
No. of Cylinders	1
Run Amps @ 90 PSI	12
Weight	24 lb.
CFM Displacement	6
Electrical	120/60/1
Motor	Capacitor Start
NEMA Motor Frame	56
RPM	1725
Max Pressure (PSI)	125
SCFM @ PSI	@20 5.0
	@ 40 4.1
	@ 90 3.1
	@100 2.9
	@125 2.1

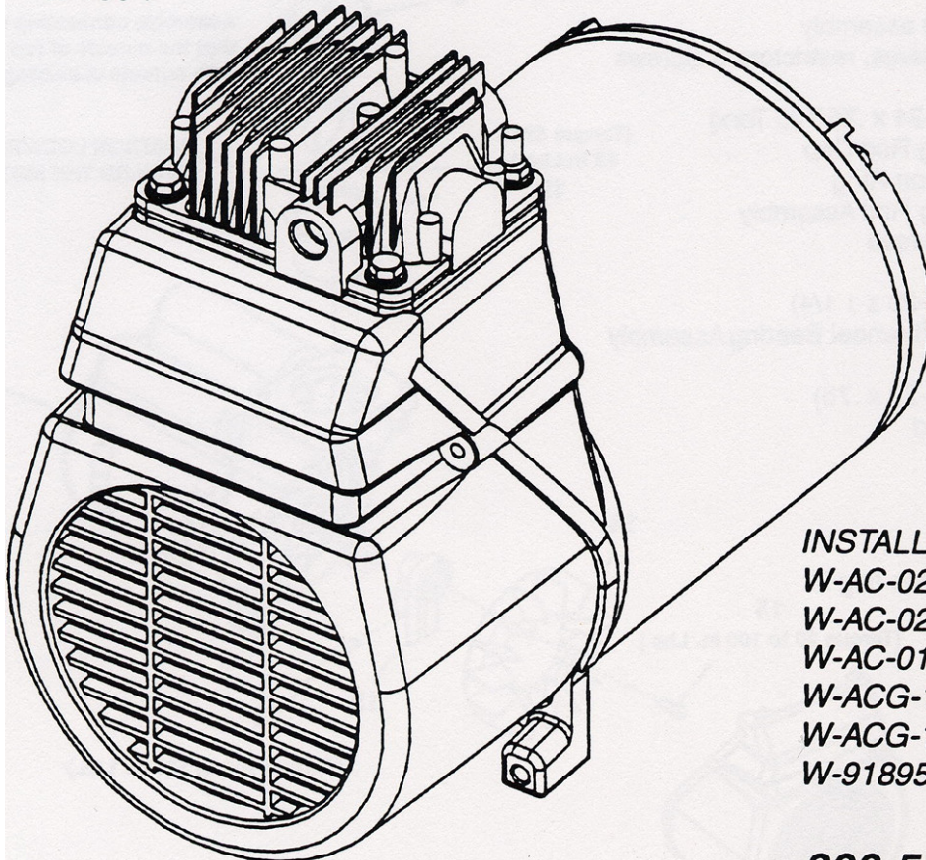
**INSTALLATION ACCESSORIES**

W-AC-0253	Air Filter Assembly
W-AC-0281	Air Filter Element
W-AC-0162	3 Point Base Mount Plate
W-ACG-18	Cup, order 2 per unit
W-ACG-19	Isolator, order 3 per unit
W-91895680	Screw, order 2 per unit

**800-540-8207****Direct Air Distributing  
Atlanta, GA**

# Parts Manual - Model No. B-OPA-0296

## OPERATING SPECIFICATIONS

Horsepower	1.5
No. of Cylinders	1
Run Amps @ 90 PSI	12
Weight	24 lb.
CFM Displacement	6.0
Electrical	120/60/1
Motor	Capacitor Start
NEMA Motor Frame	56
RPM	1725
Max Pressure (PSI)	125
SCFM @ PSI	@ 20 5.0
	@ 40 4.1
	@ 90 3.1
	@ 100 2.9
	@ 125 2.1

Key No.	Part Number	Description
1	SSF-927	Screw (1/4-20 x 1 1/8" - 4 used)
2	AC-0288	Head
3*‡	ACG-45	O-Ring
4	AC-0032	Valve plate assembly includes valves, restrictors & Screws
5*‡	SSG-8156	O-Ring
6*‡	SSF-3158-1	Screw (10-24 x .75 T25 Torx)
7*	---	Connecting Rod Cap
8*‡	---	Compression Ring
9*	---	Connecting Rod Assembly
10*‡	---	Cylinder Sleeve
11	M0-9047	Motor

